

This drawing should not be scaled. Dimensions to be verified on site.  
 Any discrepancies should be referred to the Engineer prior to work being put in hand.  
 This drawing is the property of Waterman Moylan Consulting Engineers Limited and is issued on the condition that it is not copied, reproduced, retained or disclosed to any unauthorized person, either wholly or in part without the consent in writing of Waterman Moylan Consulting Engineers Limited.  
 Block 5 East Point Business Park, Dublin D03 H3F4 Ireland  
 t+353 1 664 8900

- NOTES:
- DO NOT SCALE. USE FIGURED DIMENSIONS ONLY.
  - THIS DRAWING IS TO BE READ IN CONJUNCTION WITH ALL OTHER RELEVANT ARCHITECTURAL AND ENGINEERING DRAWINGS.

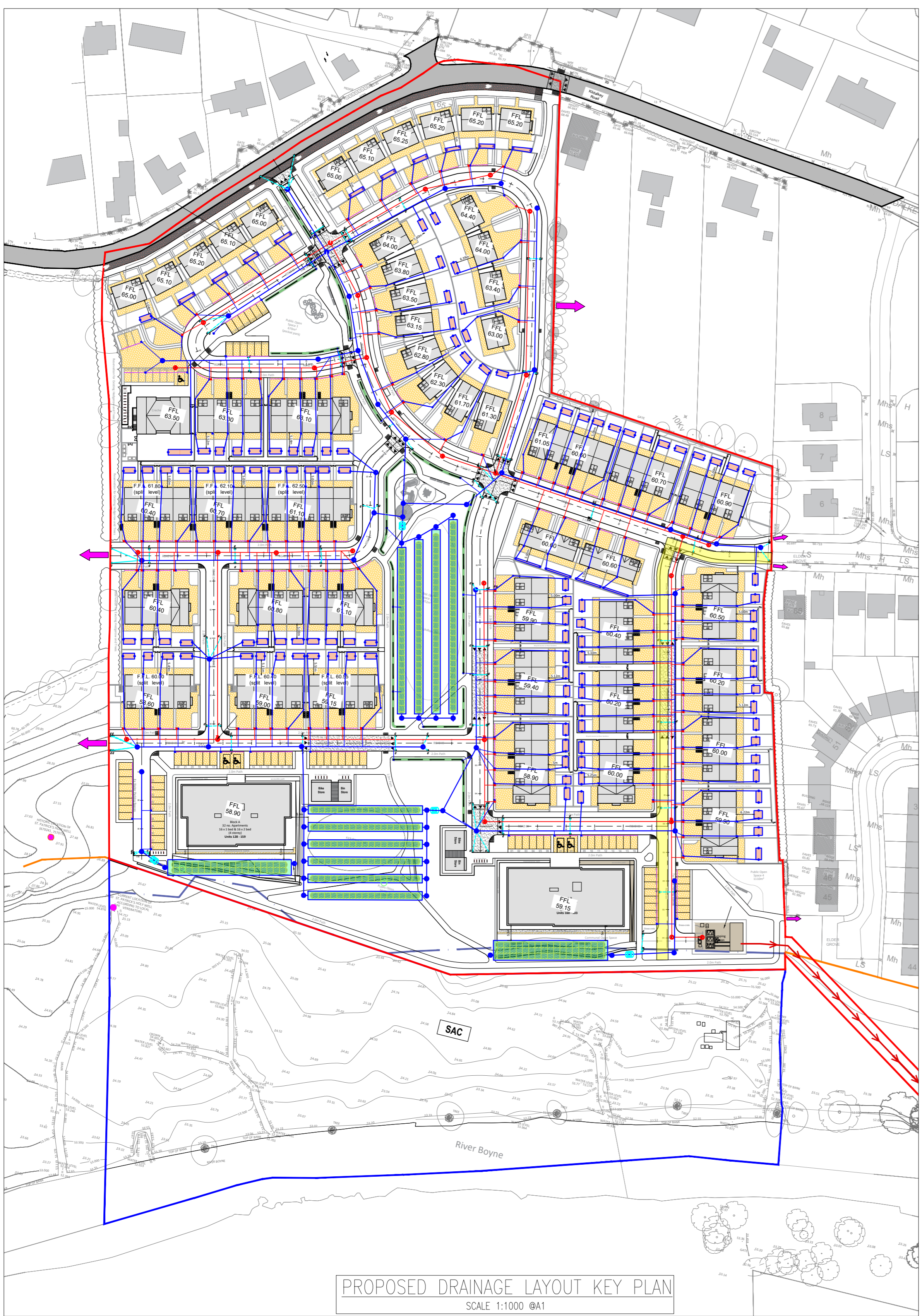

PROPOSED DRAINAGE LAYOUT KEY PLAN  
 SCALE 1:1000 @A1

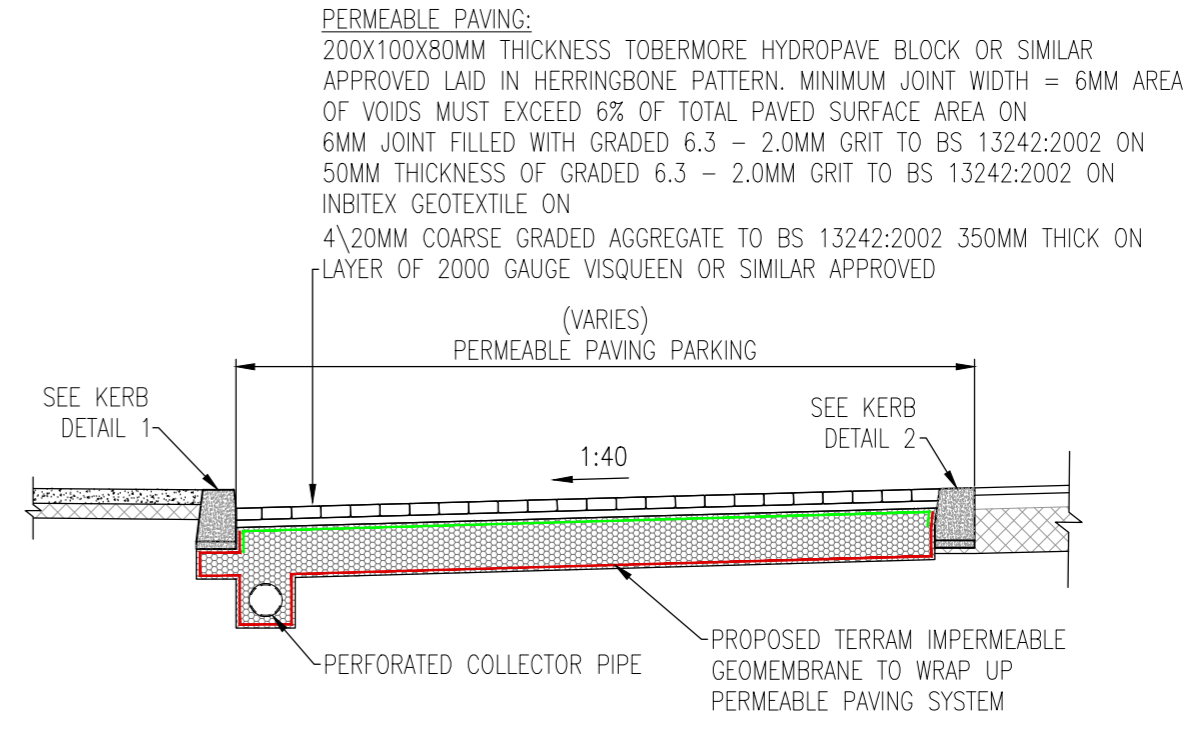

TYPICAL SECTION THROUGH PERMEABLE PAVING PARKING  
 SCALE 1:50

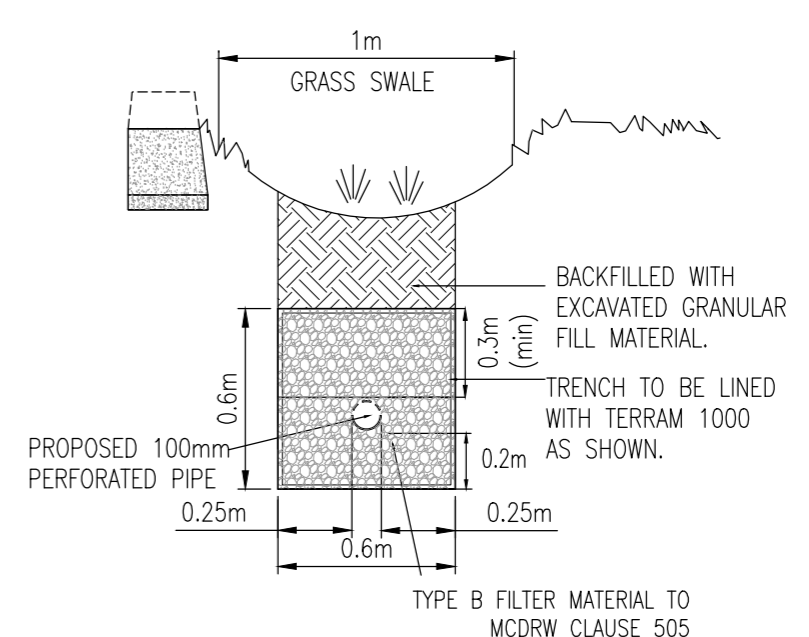

TYPICAL SECTION THROUGH PROPOSED SWALE  
 SCALE 1:25 @A1

Ordnance Survey Ireland Licence  
 No. EN 0006025 © Ordnance Survey Ireland/Government of Ireland.

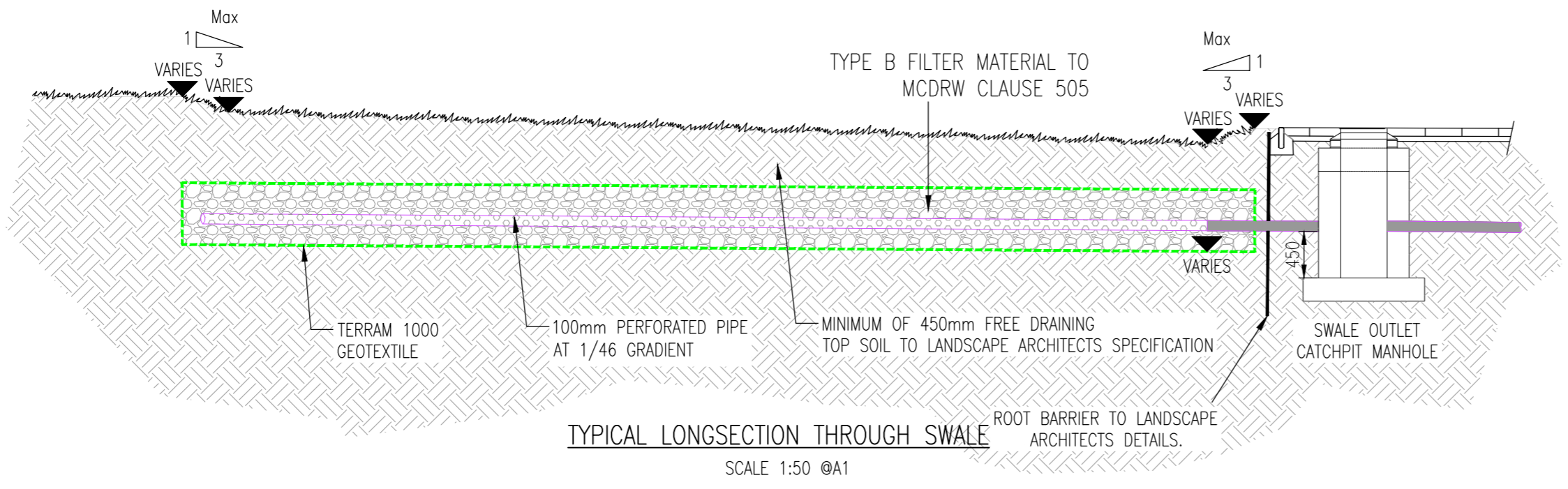
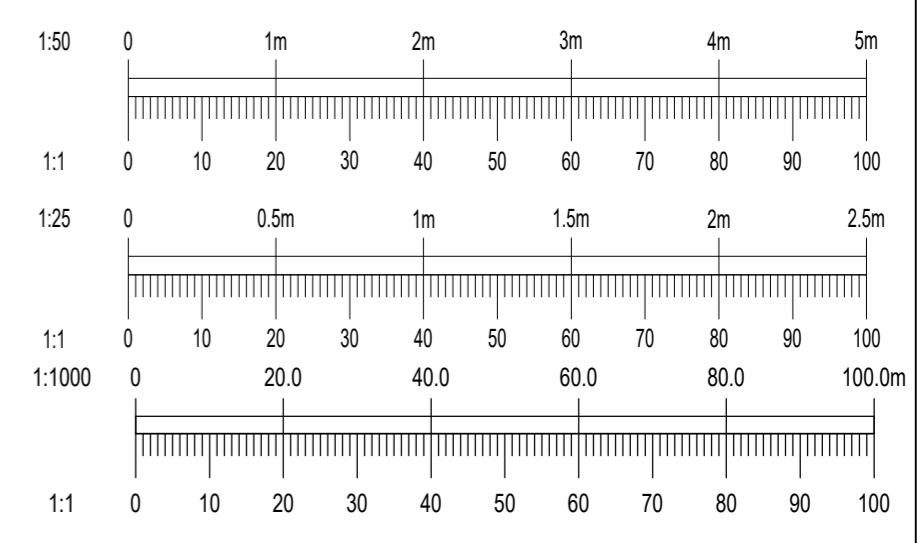

TYPICAL LONGSECTION THROUGH SWALE  
 SCALE 1:50 @A1

Rev	Date	Description	By	Chk
Amendments				
Project: <b>KILDALKEY ROAD, TRIM, CO. MEATH</b>				
Title: <b>TYPICAL SUDS DETAIL</b>				
Client: <b>LOUGHLINN DEVELOPMENTS LIMITED</b>				
<b>waterman moylan</b>				
BLOCK 5, EASTPOINT BUSINESS PARK, ALFIE BYRNE ROAD, DUBLIN D03 H3F4 IRELAND. Tel: (01) 664 8900 Email: info@waterman-moylan.ie www.waterman-moylan.ie				
<b>FOR PLANNING ONLY</b>				
Designed By	SK	Approved	BG	Waterman Ref: 23-041
Drawn By	SH	Date	MAY. 2026	Series @A1 AS SHOWN@A1
Project - Originator - Volume - Level - Type - Role - Number				Revision
TRIM - WAT - ZZ - XX - DR - C - P225				

Drawing Location: N:\Projects\23041-Kildalkey Road\Waterman Moylan\Civil\Planning\Autocad Drawings\23-041-P225 - Typical SUDS Detail.dwg  
 Date: Jun 18, 2026 - 2:41pm